

# MINIMUM ROUND SINGLE

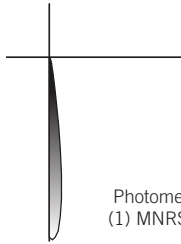

Photometric Drawing for  
(1) MNRS-30D-WHW-120

TYPE \_\_\_\_\_ PROJECT \_\_\_\_\_



## CATALOG NUMBER

| FITTURE     |                      | DISTRIBUTION |                | COLOR      |                           | VOLTAGE    |       |
|-------------|----------------------|--------------|----------------|------------|---------------------------|------------|-------|
| <b>MNRS</b> | Minimum Round Single | <b>30D</b>   | 30 degree lens | <b>WHW</b> | Warm White LED<br>(3000K) | <b>120</b> | 120 v |

## SPECIFICATIONS

**Construction.** Fixture body and LED housing are constructed of machined aluminum.

**Shielding.** Integral 30 degree spread lens for maximum efficiency and optimization of the LED chips.

**Finish.** Fixture and LED housings are brushed, anodized aluminum.

**Electrical.** Fixture is available in 120 volts. Fixture is UL/CUL Listed. Supplied with integral 3.6W LED driver.

**Lamping.** (1) 1.2W Osram Oslon LED chip.

**Mounting.** Fixture surface mounts over a standard octagonal junction box. See Installation instructions for additional detail. **ADA Compliant.**

**Warranty.** 5 years. LED rated life is 50,000 hours to 70% of lumen output.

## DIMENSIONS & DETAILS

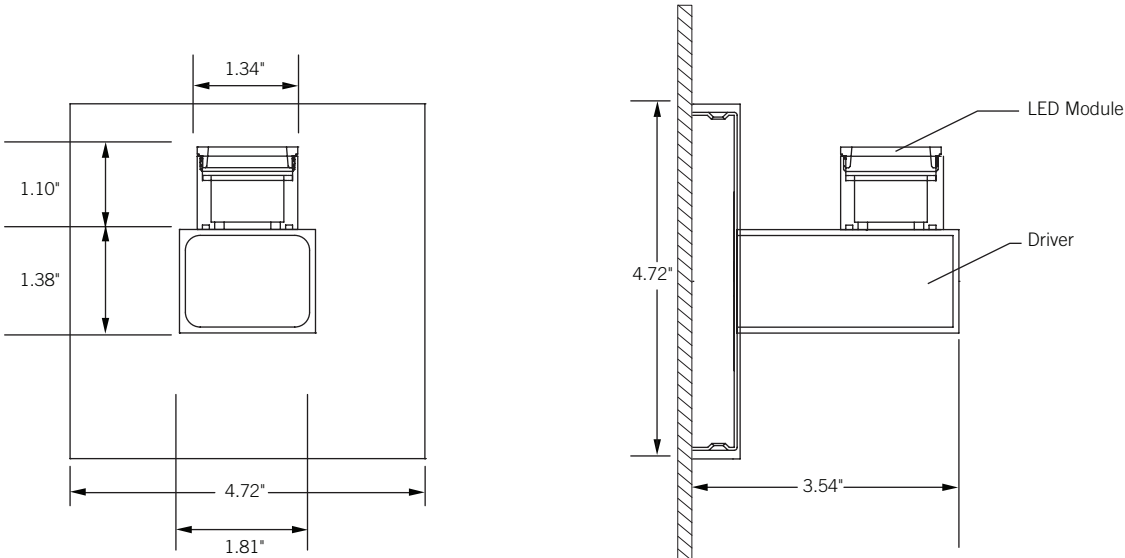

Installation instructions may be found at [www.energielighting.com](http://www.energielighting.com).

**Tons:**

™ Energie LLC, 4885 Ward Road, Ste. 300, Wheat Ridge, CO 80033 Tel 720.963.8055 Fax 720.963.8044 [www.energielighting.com](http://www.energielighting.com)  
In an effort to continually improve our products, we reserve the right to change or modify designs and/or materials without prior notice.  
All rights reserved. These products may be covered by one or more U.S. or international patents or patents pending. 05/13

énergie®

# MINIMUM ROUND SINGLE

TYPE \_\_\_\_\_  
PROJECT \_\_\_\_\_

## PHOTOMETRICS

MNRS-30D-WHW-120

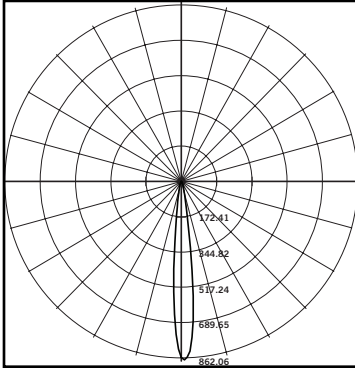

### LUMINAIRE

**Description:** Minimum Round Single  
**Catalog Number:** MNRS-30D-WHW-120  
**Initial Lumens:** 80  
**Fixture Lumens:** 67  
**Efficiency:** 83%  
**Distribution:** 100% in either direction (depends on mounting)  
**CRI:** > 80

### CANDELA DISTRIBUTION

|    | 0     | 30    | 60    | 90    | 120   | 150   | 180   |
|----|-------|-------|-------|-------|-------|-------|-------|
| 0  | 844.8 | 844.8 | 844.8 | 844.8 | 844.8 | 844.8 | 844.8 |
| 5  | 539.9 | 480.4 | 521.1 | 667.2 | 631.2 | 660.8 | 502.4 |
| 15 | 47.9  | 44.4  | 49.6  | 60.8  | 57.4  | 60.7  | 49.4  |
| 25 | 16.1  | 15.0  | 15.4  | 17.9  | 17.4  | 17.6  | 16.2  |
| 35 | 5.5   | 5.4   | 5.6   | 6.4   | 6.3   | 6.4   | 5.9   |
| 45 | 2.5   | 2.5   | 2.5   | 2.8   | 2.9   | 2.8   | 2.7   |
| 55 | 1.3   | 1.3   | 1.2   | 1.4   | 1.4   | 1.4   | 1.3   |
| 65 | 0.6   | 0.7   | 0.6   | 0.7   | 0.7   | 0.7   | 0.7   |
| 75 | 0.3   | 0.3   | 0.2   | 0.3   | 0.3   | 0.3   | 0.3   |
| 85 | 0.0   | 0.0   | 0.0   | 0.0   | 0.0   | 0.0   | 0.0   |
| 90 | 0.0   | 0.0   | 0.0   | 0.0   | 0.0   | 0.0   | 0.0   |

### LUMINANCE (Candela/sq meter)

| ANGLE | 0-DEG | 90-DEG |
|-------|-------|--------|
| 45    | 39711 | 35553  |
| 55    | 23833 | 22037  |
| 65    | 15996 | 14954  |
| 75    | 10780 | 9659   |

### COEFFICIENTS OF UTILIZATION

| RC<br>RW | 80 |    |    | 70 |    |    | 50 |    |    | 30 |    |    | 10 |    |    | 0  |
|----------|----|----|----|----|----|----|----|----|----|----|----|----|----|----|----|----|
|          | 50 | 30 | 10 | 50 | 30 | 10 | 50 | 30 | 10 | 50 | 30 | 10 | 50 | 30 | 10 | 0  |
| 0        | 99 | 99 | 99 | 96 | 96 | 96 | 92 | 92 | 92 | 88 | 88 | 88 | 85 | 85 | 85 | 83 |
| 1        | 97 | 97 | 96 | 96 | 95 | 94 | 92 | 91 | 90 | 87 | 86 | 86 | 81 | 80 | 79 | 75 |
| 2        | 94 | 93 | 93 | 92 | 91 | 91 | 89 | 88 | 87 | 84 | 83 | 82 | 79 | 78 | 76 | 73 |
| 3        | 91 | 90 | 89 | 89 | 88 | 87 | 86 | 84 | 83 | 82 | 80 | 79 | 77 | 75 | 74 | 70 |
| 4        | 88 | 87 | 87 | 86 | 85 | 85 | 83 | 82 | 81 | 80 | 78 | 76 | 75 | 73 | 72 | 68 |
| 5        | 86 | 85 | 84 | 84 | 83 | 82 | 81 | 79 | 78 | 78 | 76 | 74 | 74 | 71 | 70 | 66 |
| 6        | 83 | 83 | 82 | 82 | 81 | 80 | 79 | 77 | 76 | 76 | 74 | 72 | 72 | 70 | 68 | 65 |
| 7        | 81 | 81 | 80 | 80 | 79 | 78 | 77 | 76 | 74 | 74 | 72 | 70 | 71 | 68 | 66 | 63 |
| 8        | 80 | 79 | 79 | 78 | 77 | 77 | 75 | 74 | 73 | 72 | 70 | 69 | 69 | 67 | 65 | 62 |
| 9        | 78 | 77 | 77 | 77 | 76 | 75 | 74 | 72 | 71 | 71 | 69 | 67 | 68 | 65 | 63 | 61 |
| 10       | 77 | 76 | 76 | 75 | 74 | 74 | 73 | 71 | 70 | 70 | 68 | 66 | 67 | 64 | 62 | 59 |